

RIG 800 series

RIG 800HS, RIG 800HX

User Guide

Contents

Setup and basics	3
Fit	3
Setup PS4	4
Setup Xbox One	4
Charge	5
Adjust volume	6
Mute	6
Set EQ	6
Support	8

Setup and basics

Your adapter comes pre-paired to your headset. After you adjust and charge your headset and configure your adapter, power on your headset and it's ready to go.

- Fit Your headset components easily snap into the headset frame to configure the best fit and sound. The headband adjusts to three sizes (small, medium, large) by moving the earcups. To remove an earcup, press the earcup to detach it from the headband.

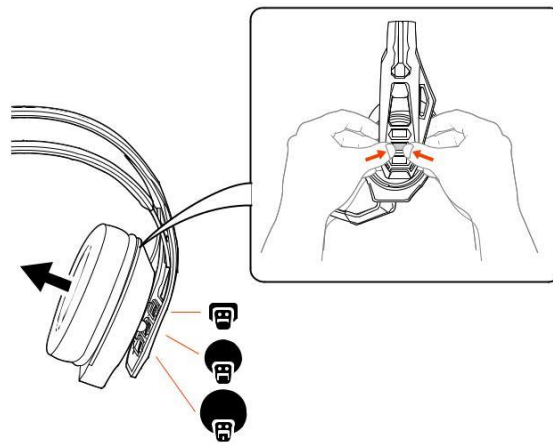

Setup PS4

PS4

- 1 Connect your adapter to your system.

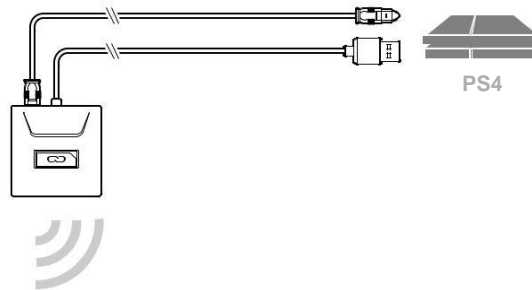

- 2 Power on your PS4 and Check for updates
- 3 Go to Settings > Sound and Screen > Audio Output Settings > Select Digital Out (Optical)
- 4 Go to Settings > Devices > Audio Devices > Output Devices Select Plantronics RIG800XX

PS4 (slim version)

- 1 Connect your adapter to your system.

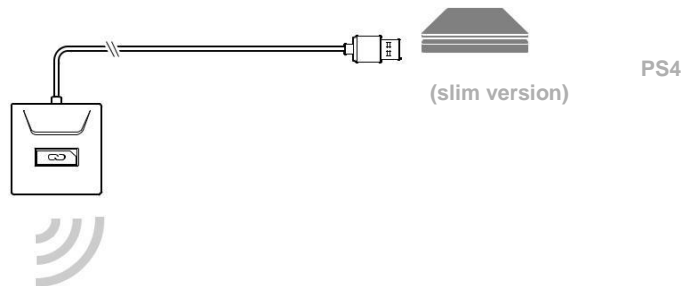

- 2 Power on your PS4 and Check for updates
- 3 Go to Settings > Devices > Audio Devices > Output Devices Select Plantronics RIG800XX
- 4 Go to Settings > Devices > Audio Devices > Output to headphones > All audio

Setup Xbox One

Connect your adapter to your system.

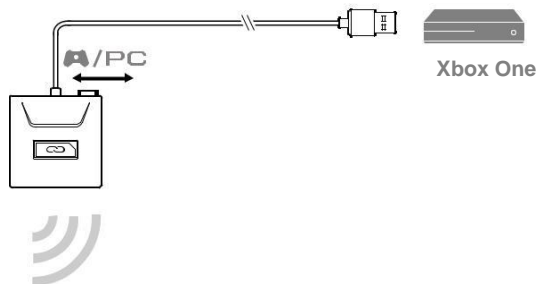

NOTE Ensure the switch on the back of the adapter is set to your preference: console or PC.

- 2 Power on your Xbox One and Check for updates
- 3 Go to All settings > Kinect and Devices > Device Options and Accessories > Assign

Charge It takes up to 4.5 hours to fully charge your headphones. The headset LED is red while charging and turns off when complete.

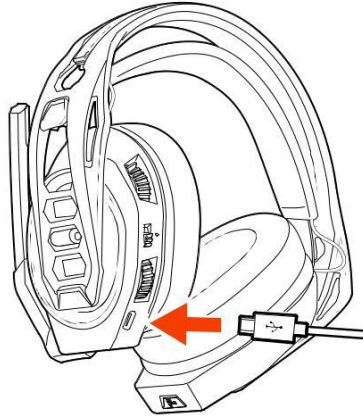

⌚ 04:30:00 = 🔋 100%

- Adjust volume
- 1 To increase or decrease the game and chat volume, adjust the top headset dial.
 - 2 To increase or decrease the master volume, adjust the bottom headset dial.

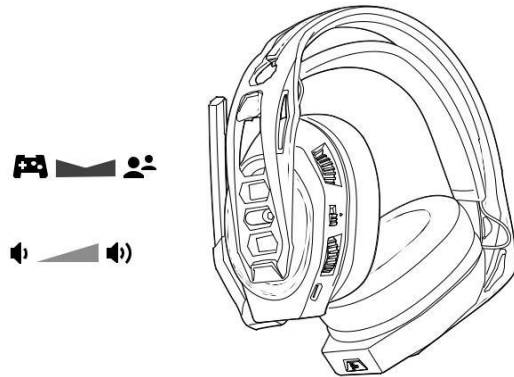

IMPORTANT For the PS4 (slim version), set the top headset dial in the middle; game and chat remain balanced. Use the bottom headset dial to increase or decrease the master volume.

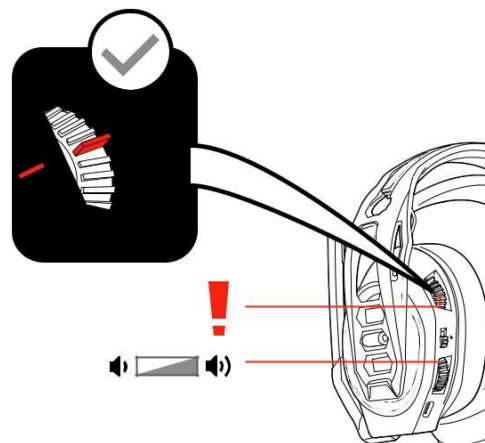

- Mute
- Lift the boom to a full stop to mute the microphone.

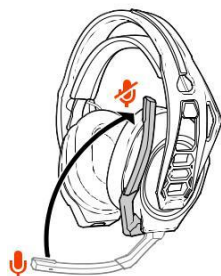

CAUTION Do not force the boom past its upper or lower limits.

- Set EQ
- Cycle through the EQ modes by tapping the EQ button.

Tap the EQ button and hear	EQ mode
one tone	Pure EQ maintains high frequencies.
two tones	Seismic EQ emphasizes mid-range sounds.
three tones	Intensify EQ boosts bass.
four tones	Vocal Focus EQ
